

ASSESSCO [SSCCSG - G'] Rain Head Gutter System®

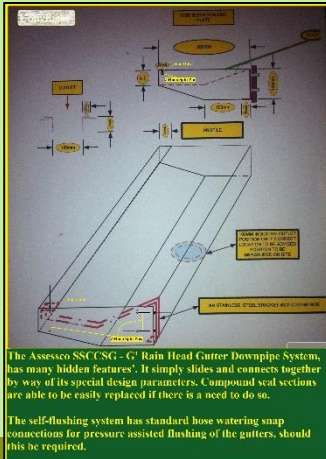

Notations

- 1) The Assessco Rain Head Gutter System is designed for both residential and commercial buildings.
- 2) The main sections are fitted, from zero to one degree of fall, to the position of downpipe discharge.
- 3) Customized fittings are available for securing of 100 mm stainless steel downpipes.
- 4) The system has an additional attachment for flushing with pressurized water, via a hose connection.
- 5) Made to order, lead time 31 days on confirmation, delivery to be advised.



Material composition.

Either 304 or 316 Stainless Steel, Copper, ColorSteel or Galvanized Steel

FEATURES

The Assessco [SSCCSG - G'] Rain Head Gutter System, incorporates 'slideway' joint connection for sustainable proficiency.

A water shed self-cleaning system, uses the water volume and flow to keep the gutters clean and clear of debris.

Seals are applied in a one piece section between the internal joints, and seals are readily replaceable if there is a need to. The system can be dismantled easily for cleaning and polishing if required and then can be reinstated.

There is no requirement for screws or rivets, other than for the mounting brackets. No material welding or mitre joints required. A discharge hole, punched at 105 to 108mm, to be applied for a downpipe discharge dropper. [AGM'100mm].

Gutter profile lengths are supplied 0.5mm up to eight metres in length [8m].

For the ASSESSCO [SSCCSG - G'] Rain Head Gutter System Estimator pre-ordering document: refer - SSCCSG - G' page, attached within our email, or download from our Web-Page at www.Assessco.co.nz

Franchise options available for this product design and implementation. Contact: - AGM International Group's principal for additional information. ©

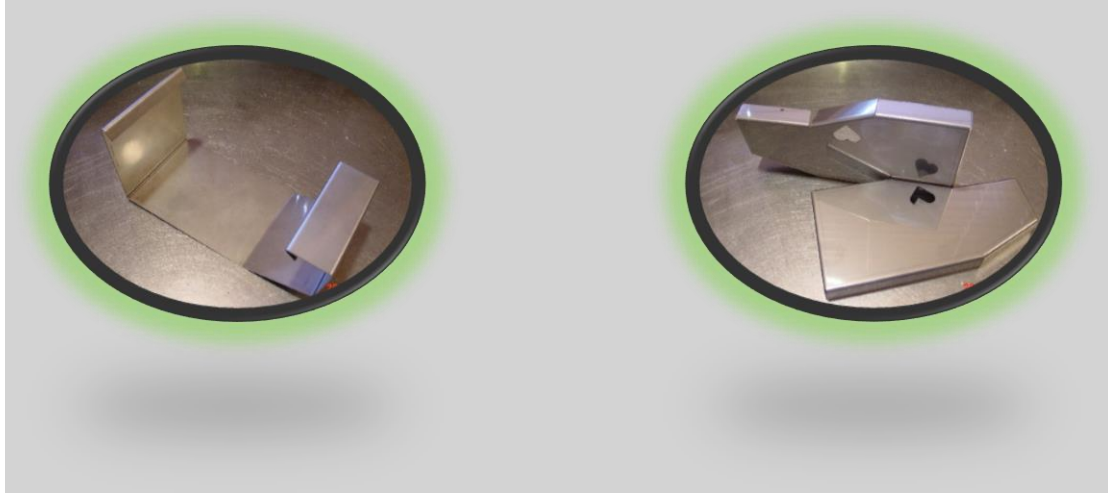

Figure 1 Indicative Picture Sample only

ASSESSCO [SSCCSG - G'] Rain Head Gutter

ASSESSCO [SSCCSG - G'] Rain Head Gutter System

Metal Sections ©



Joiner [AGM-1] / End caps [AGM-2-R & L] ©

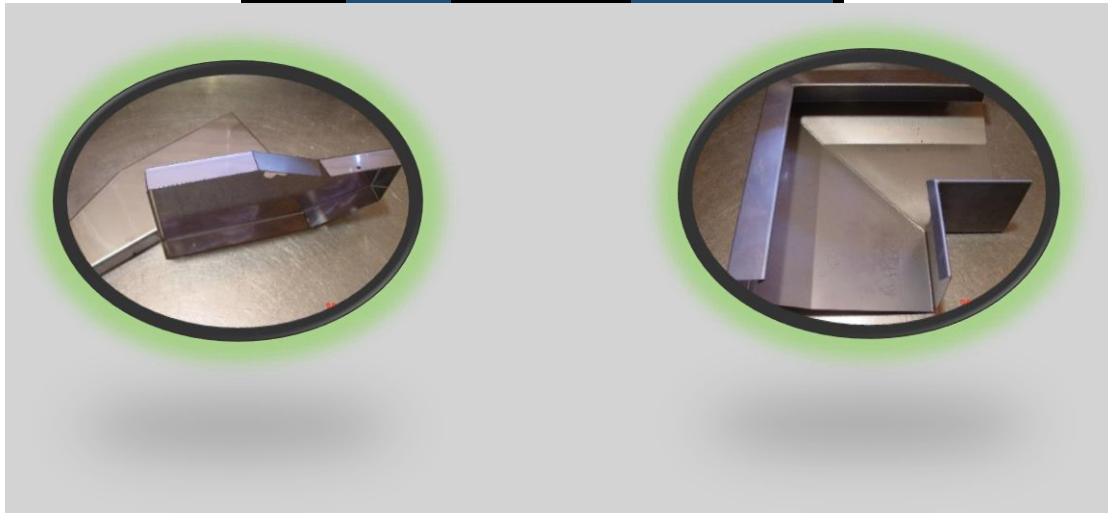

End caps [AGM-2-R & L] / External corner [AGM - 3]

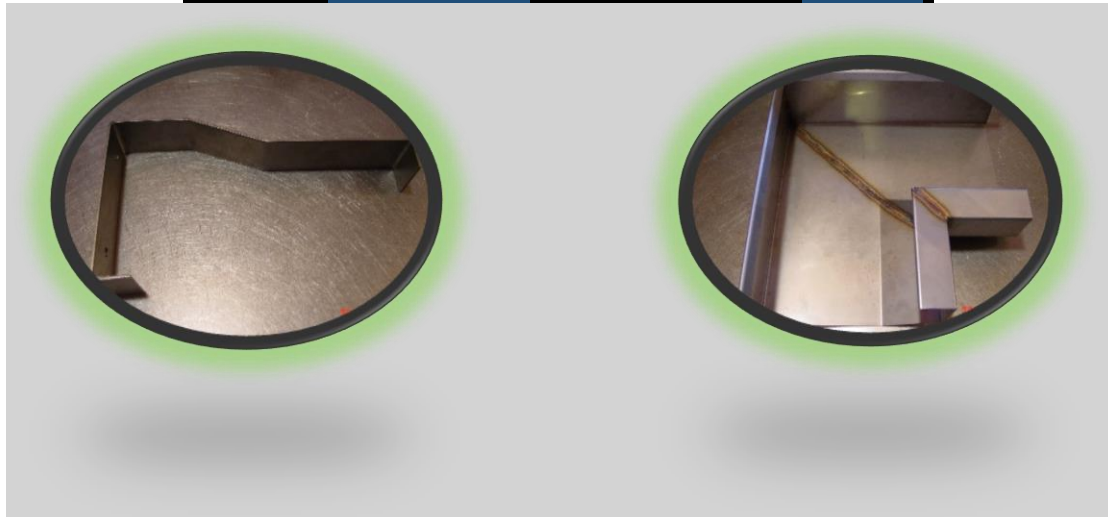

Mounting bracket [AGM - 4] / Internal corner [AGM - 5] Gutter section [AGM - 6] ©

Lengths 500mm to 8 metres \ / Gutter section [AGM - Measurements to be supplied?] \ / 8m

ASSESSCO [SSCCSG – G'] Rain Head Gutter System, sections up to 8 metres in length
Affixed with 2.7 x 25.4mm stainless steel split pins and joint seals ©

ADDITIONAL INFORMATION

The present Health and Safety and the Employment Act, has a number of significant penalty and liability provisions in consequence for companies and their employees when employees are working at elevated heights. Navigating roofs and high mounted watershed storm water drainage systems within the gutter and downpipe systems presents a real and manageable risk to safety of employees responsible for keeping these systems maintained. This includes keeping the system free from debris and contamination to minimise ponding and resultant weather tight issues.

The costs of scaffolding and scissor lifts are an added but necessary cost requirement, as part of a construction process but may also be necessary whenever routine maintenance is undertaken. The design features and performance of the **ASSESSCO [SSCCSG - G'] Rain Head Gutter System[©]** significantly contributes to future to reduce costs of construction and that of ongoing maintenance over the years for the life of a building.

The **ASSESSCO [SSCCSG - G'] Rain Head Gutter System[©]** incorporates an additional piped pressurized water flushing system, being attached at the end of each 200mm gutter sections This is used from time to time to flush out any residual debris caused by long dry periods, or high wind generated accumulations after any active storm, and is designed to direct such debris elements towards the nearest down-pipe exit receptor.

The water intake connection locations are applied at ground level for ease of attachment to a garden hose. Water is piped to the pressurizing nozzle positioned within the system. The piped water supply connection is secured, behind any one down-pipe, and is largely unable to be seen for aesthetic reasons.

The **ASSESSCO [SSCCSG - G'] Rain Head Gutter System[©]** watershed gutter system is easily assembled with its seal attachment. There is no requirement for screws or rivets, other than for the mounting brackets which are mounted to the fascia board at 1.200 metre centre. No material welding or mitre joints are required. A discharge hole is punched at 102 mm, for a downpipe discharge dropper, [AGM'100mm]. All the associated internal and external angle corner sections are pre-made to any specific building design; note the material sections in the photo images for visual clarification.

The **Gutter section [AS - 6]** can be can be supplied in four (4) metre sections for ease of transportation, or where location access is difficult. The **ASSESSCO [SSCCSG - G'] Rain Head Gutter System[©]** comes as a kit set solution for all building requirements. Horizontal to vertical angled slide-way sections are CAD designed, and are manufactured as individual sections for the particular building application.

Measuring Procedure. A roof plan elevation is required. A Google maps printed screenshot can suffice with measured lengths in any one lineal direction drawn on. This can then be scanned and a copy forwarded to our email address at assessco.forensic@gmail.com. Once received a proof will be applied and returned to be checked and signed off, prior to processing the order.

Note item 5 on the brochure: "Made to order, lead time 31 days on confirmation, delivery to be advised within the terms of the particular project". All sales are subject to an "Estimate Disclosure Advice Document" as part of any offer.

Additional Photos

Gutter Spouting Downpipe System. "Please Note Well"

Photos are indicative representations of the product for supply to the customer.

A Google map screenshot, or a plan of the building roof elevation, with applied measurements, is required. A proof will be submitted for checking before being signed-off prior to order.
Once confirmed the order can proceed to manufacture.
Email a signed copy to assessco.forensic@gmail.com



RAIN HEAD STAINLESS STEEL GUTTER SYSTEM

DRAWINGS: -

1. COVER
2. GUTTER DETAILS
3. END CAPPING DETAILS, SEALING STRIPS
4. RAIN WATER PIPE ASSEMBLY
5. TYPICAL ASSEMBLY DETAIL

DRAWN	DRAWING	ISSUE	ISSUE DATE
RAYMOND WILSON	DETAIL DRAWINGS	R1	1/29/2017
			1

ASSESSCO (SSCCSG - G')

Rain Head Gutter System©

PROJECT MANAGER			
NAME			
CELL		A/HRS	
E-MAIL			

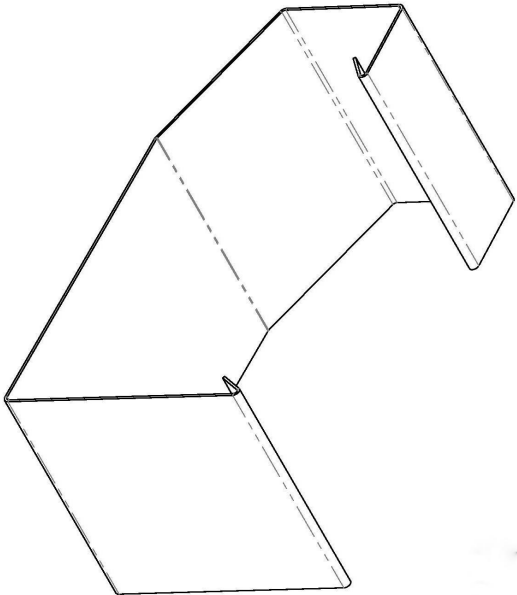

GUTTER PROFILE JOINER

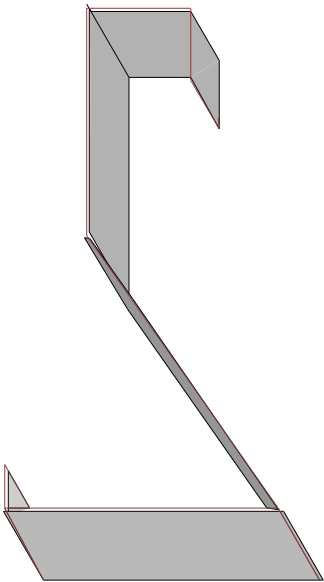

BRACKET

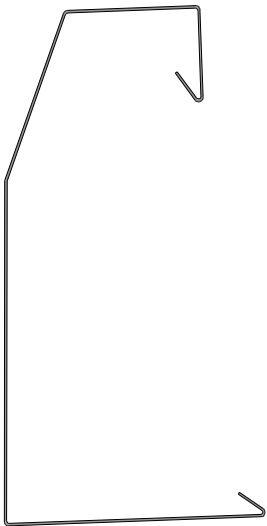

GUTTER PROFILE

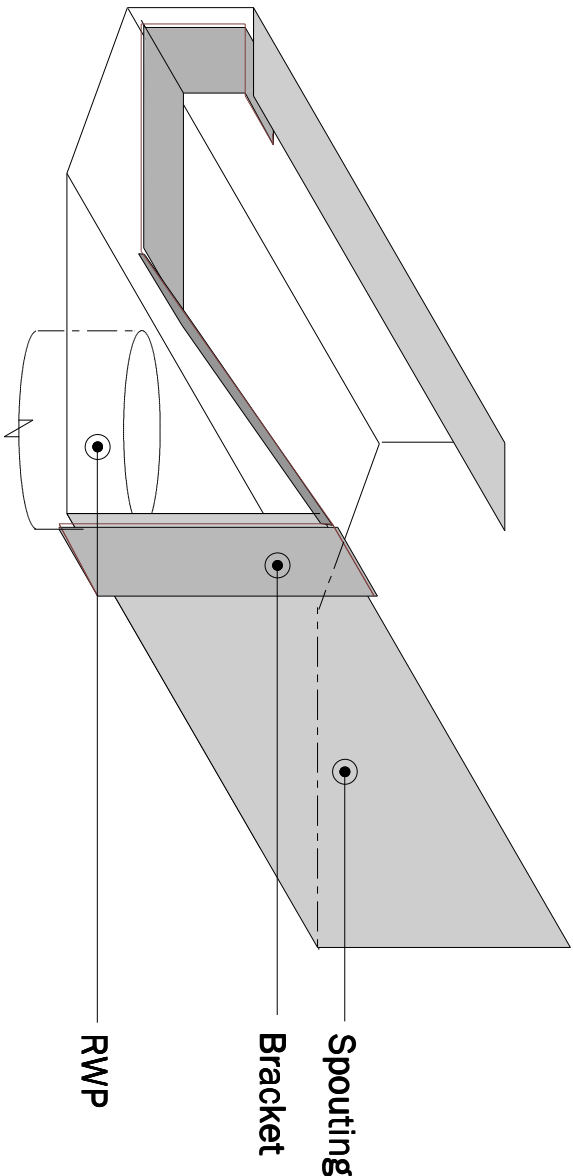

SKETCH VIEW

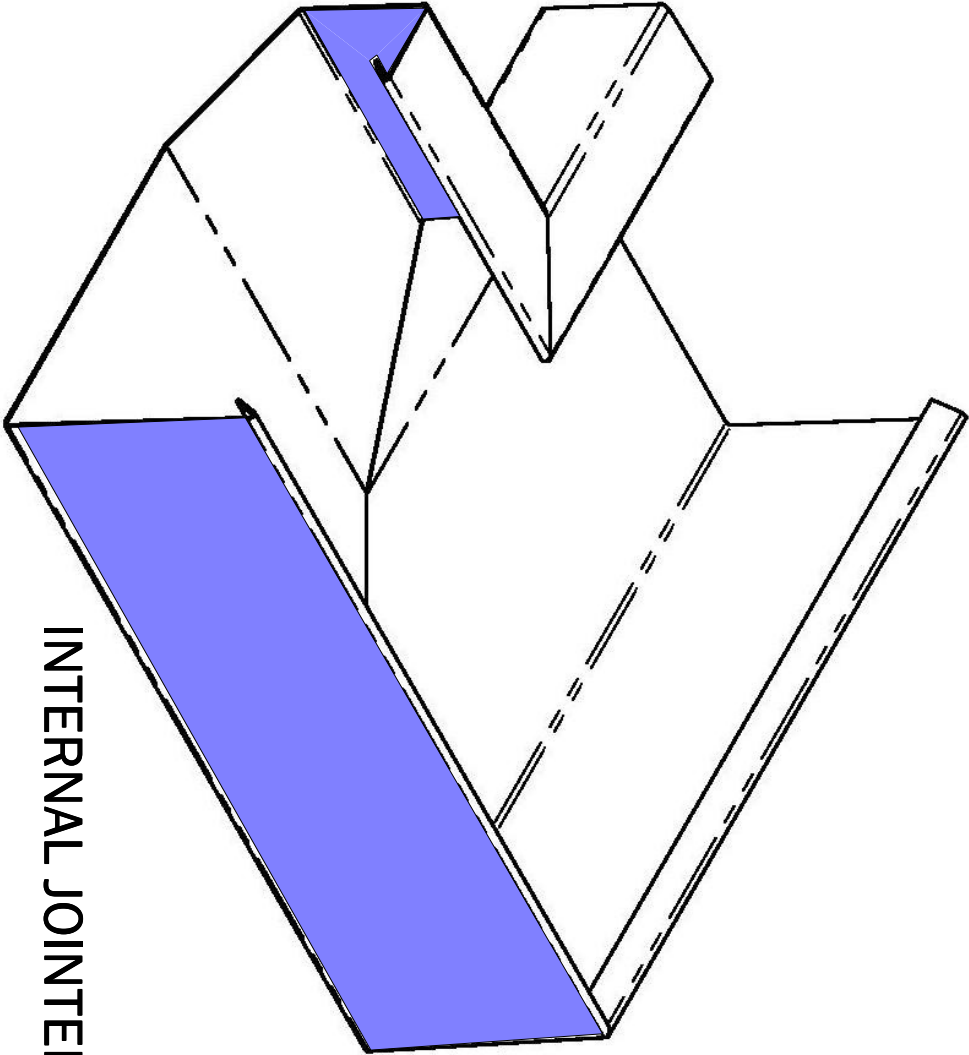

INTERNAL JOINTER

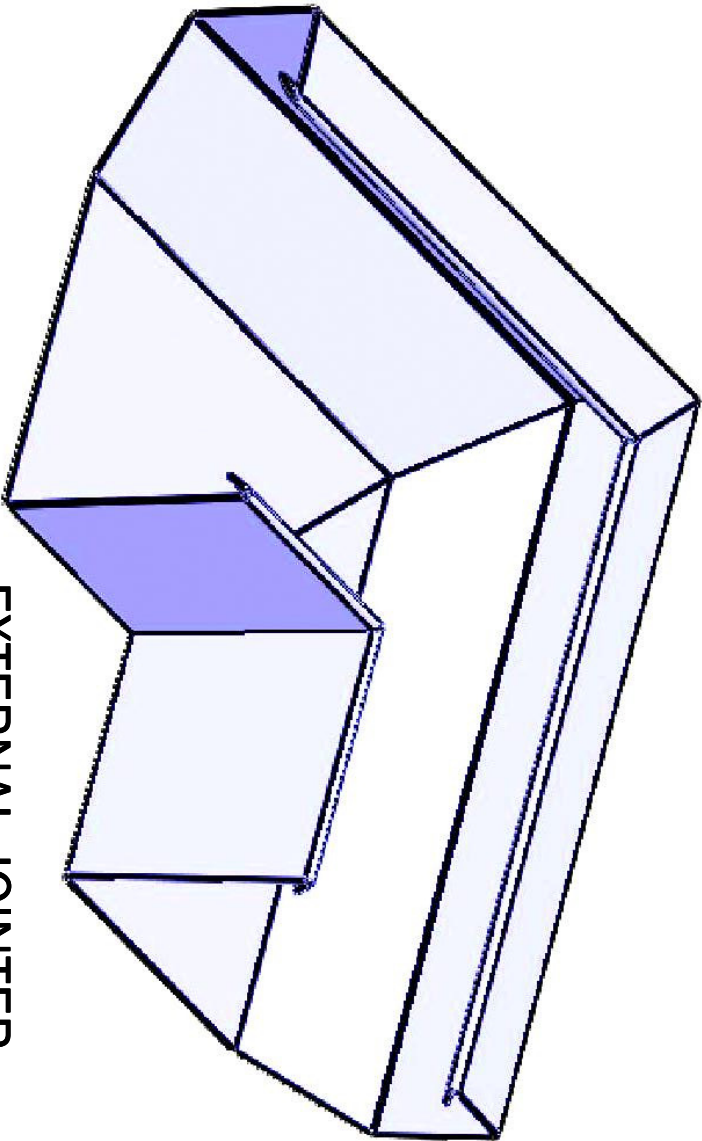

EXTERNAL JOINTER

GUTTER - DETAILS 1:4

MATERIAL SPECIFICATION

Gutter material - SS304 or SS316

Cream Fin Seal - Grade H0802XX

Black Edge Grooved Trim Seal - X1013WB

Silicone Sealer - Clear, White, Grey - Product Code

9300697115607

DRAWN	DRAWING	ISSUE	ISSUE DATE
RAYMOND WILSON	DETAIL DRAWINGS	R1	1/29/2017
			2

ASSESSCO (SSCCSG - G')

Rain Head Gutter System©

PROJECT MANAGER			
NAME			
CELL		A/HRS	
E-MAIL			



INTERNAL SEALING STRIPS 1:2

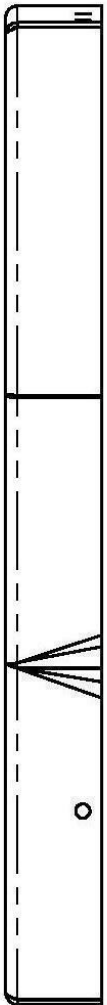

A

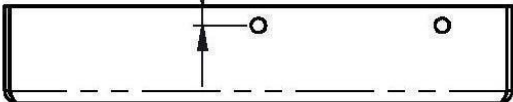

D

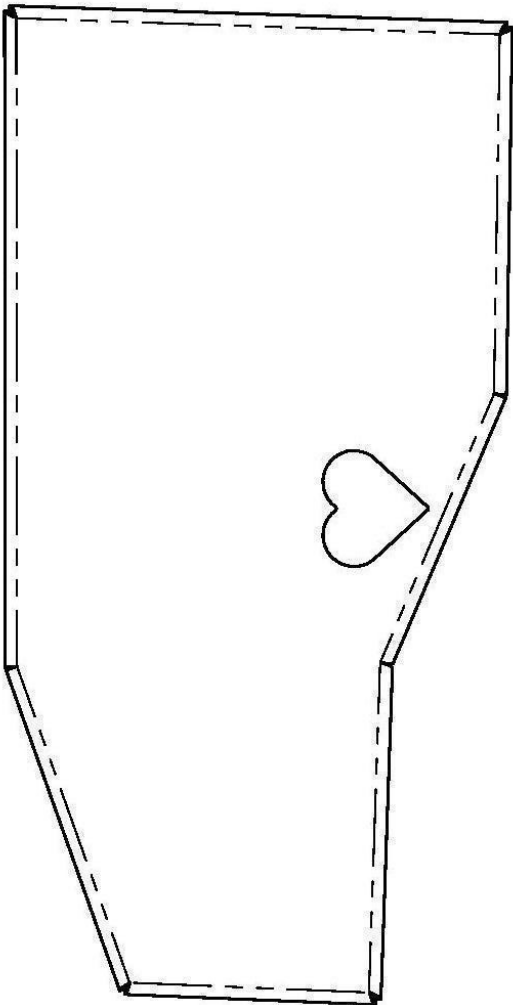

B

ELEVATIONS
(Opposite End
Handed)

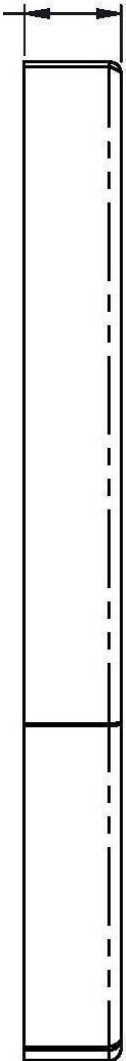

C

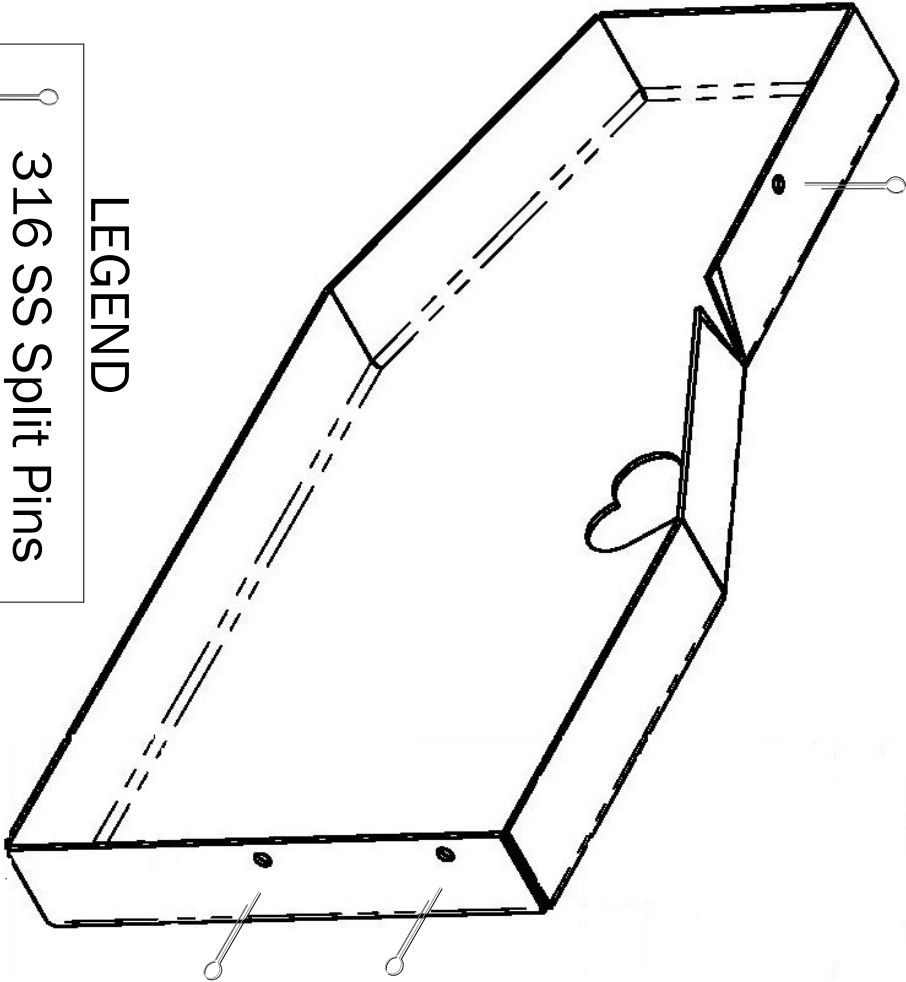

LEGEND

- 316 SS Split Pins
- Pintox M32x25

SKETCH

MATERIAL SPECIFICATION

Gutter material - SS304 or SS316
Cream Fin Seal - Grade H0802XXX
Black Edge Grooved Trim Seal - X1013WB
Silicone Sealer - Clear, White, Grey - Product Code
9300697115607

DRAWN	DRAWING	ISSUE	ISSUE DATE
RAYMOND WILSON	DETAIL DRAWINGS	R1	1/29/2017
			3

ASSESSCO (SSCCSG - G')

Rain Head Gutter System©

PROJECT MANAGER			
NAME			
CELL		A/HRS	
E-MAIL			

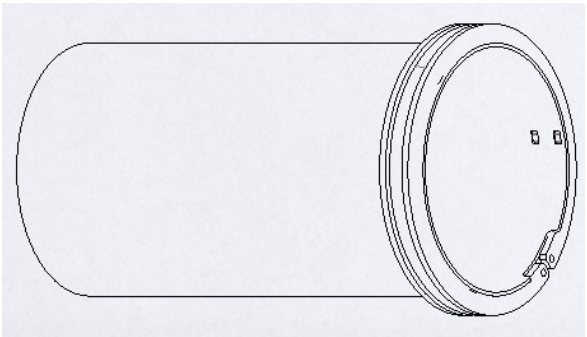
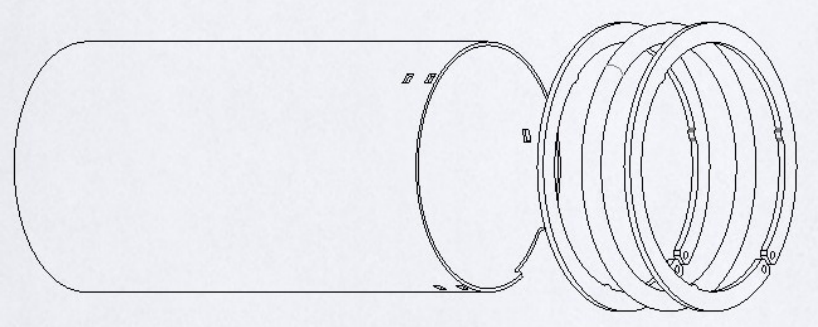
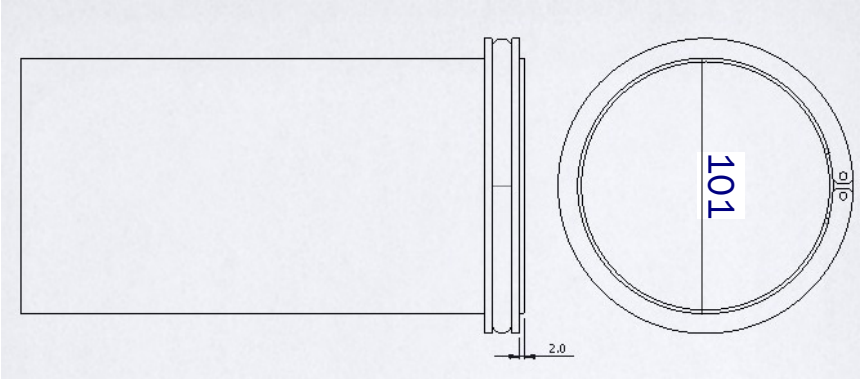
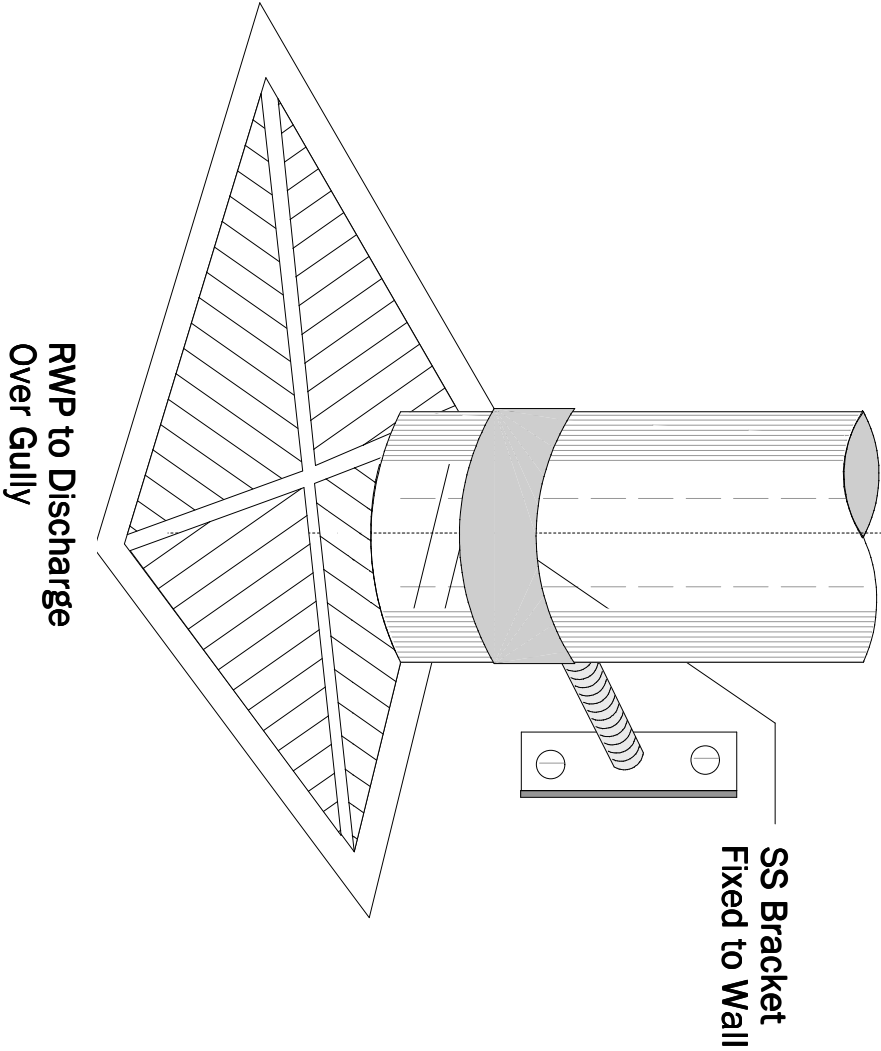
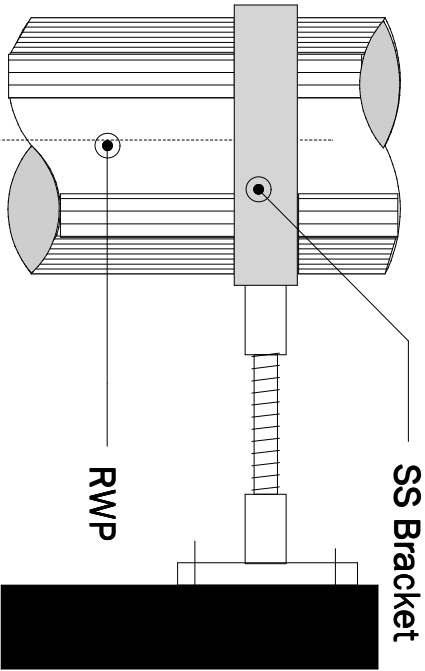
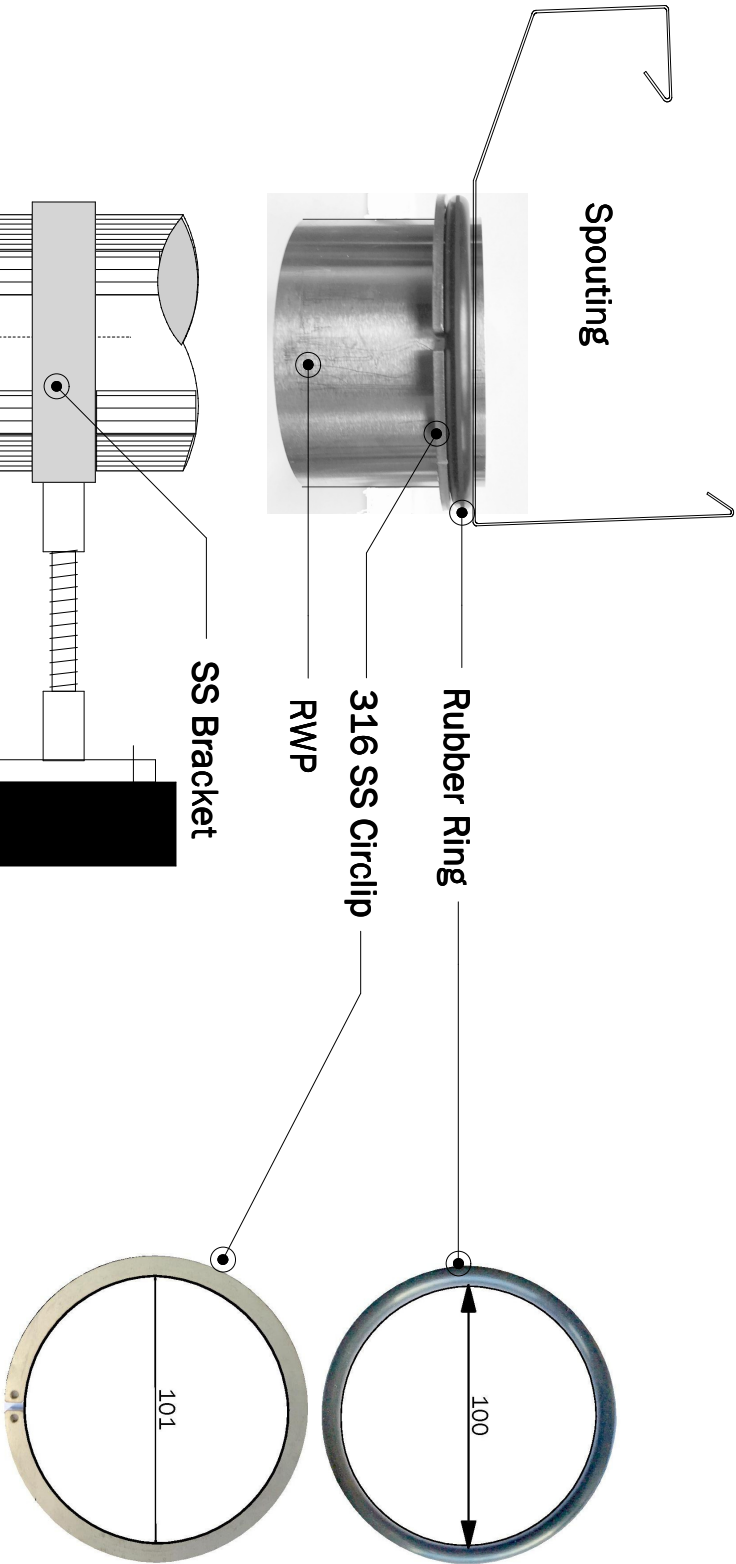

RAIN WATER PIPE - DETAILS 1:3

MATERIAL SPECIFICATION

Gutter material - SS304 or SS316

Cream Fin Seal - Grade H0802XXX

Black Edge Grooved Trim Seal - X1013WB

Silicone Sealer - Clear, White, Grey - Product Code

9300697115607

DRAWN	DRAWING	ISSUE	ISSUE DATE
RAYMOND WILSON	DETAIL DRAWINGS	R1	29-Apr-17
			4

ASSESSCO (SSCCSG - G')
Rain Head Gutter System©

PROJECT MANAGER

NAME			
CELL		A/HRS	
E-MAIL			

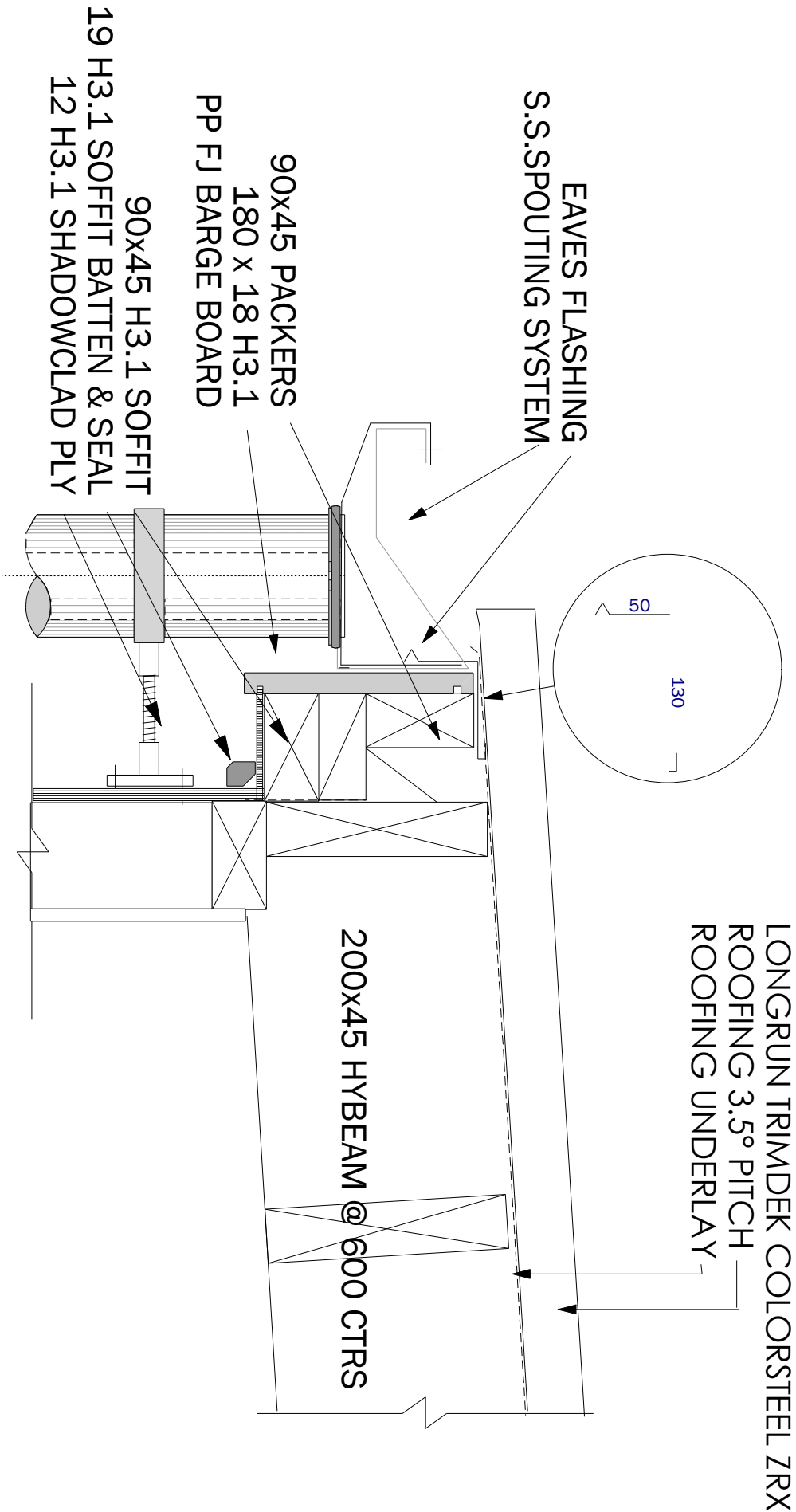

TYPICAL INSTALLATION DETAIL 1:5

DRAWN	DRAWING	ISSUE	ISSUE DATE
RAYMOND WILSON	DETAIL DRAWINGS	R1	1/29/2017
			5

ASSESSCO (SSCCSG - G')

Rain Head Gutter System©

PROJECT MANAGER			
NAME			
CELL		A/HRS	
E-MAIL			

NEW ZEALAND
Contact: (+64) (0) 27 288 6481
VERSION 150801

JDE CUSTOMER ORDER

ACCOUNT NO.	DELIVERY INSTRUCTIONS						DATE ORDER PLACED						
CUSTOMER							<div>QUOTED NO/YES NUMBER _____</div>						
							<div>ADJ SCHED (MATRIX)</div> <div>SYSTEM ORDER NO</div>						
CONTACT PHONE													
CUSTOMER ORDER NO.	DATE REQUIRED / /												
CODE	DESCRIPTION – GRADE – COLOUR – DIAGRAMS	NUMBER	LENGTH	GIRTH	TOTAL QTY	UNIT PRICE	BDL I.D.	VALUE					
FREIGHT													
NOTES									ORDER VALUE				
									G.S.T.				
									TOTAL ORDER				

COP 1001
ASSESSCO 015